

# Hex-Dec Duo

Complete with integrated dish insert



## Dimensions:

### Top

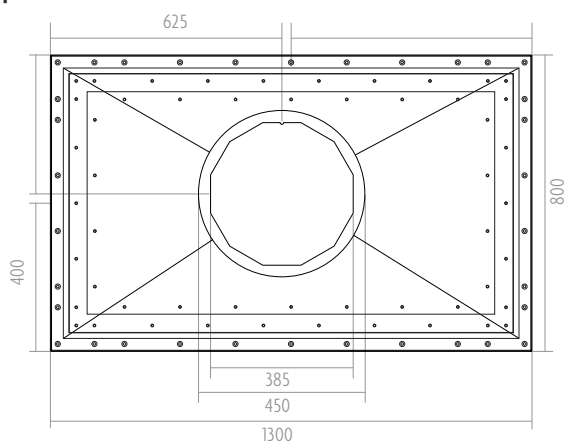

### Base

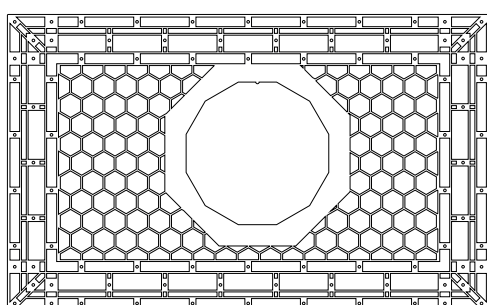

## Interlocking rotating gulley

The Hex-Dec Duo shares all of the original features and benefits of the original Hex-Dec, with the added feature of our two new rotatable waste options.

This feature will be of huge benefit where joists, pipework or underfloor obstructions may incur additional installation time and costs.

Our new unique waste inserts are dual shaped.

The round top section is 450 mm in diameter, which provides a safer and better drainage solution for vinyl floors.

The underside section is polygon in shape, which helps to lock and secure the insert within the former.

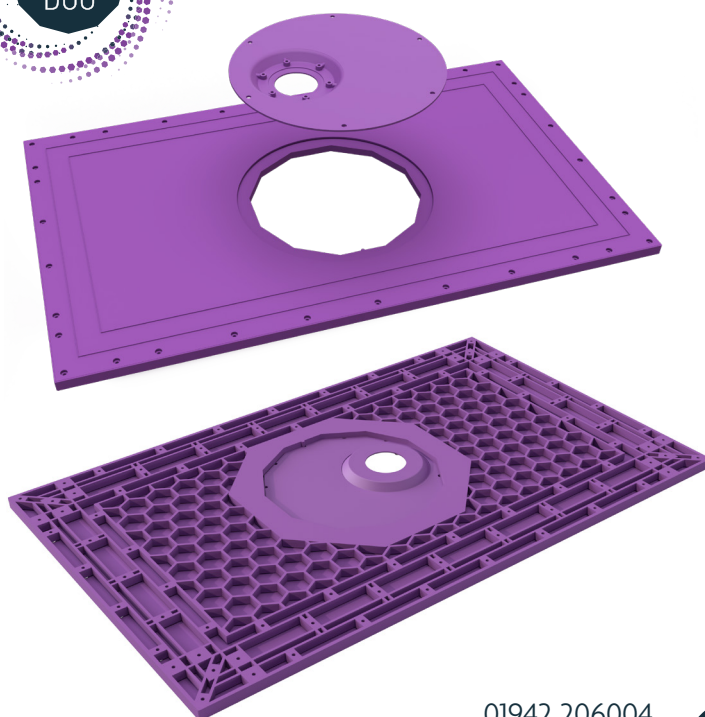

01942 206004

[sales@procare-ltd.co.uk](mailto:sales@procare-ltd.co.uk)

[www.procare-ltd.co.uk](http://www.procare-ltd.co.uk)

# Hex-Dec Duo

Complete with integrated dish insert

**PROCare**

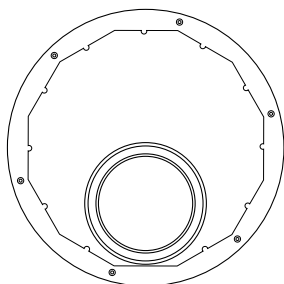
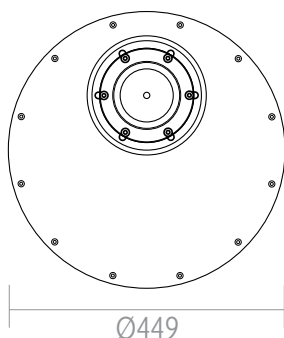

## Integrated dish Insert

- Comes as standard

This is our unique, insert and dish assembly, all in one piece, which eliminates the use of a separate dish.

The insert is manufactured in one piece which is far stronger and one less component to fit. It has been designed to accept our easy clean, fast flow gravity and pumped wastes. The new 6 stud clamp assembly offers additional strength and support for the gully top.

## Quality and strength

Whichever size and waste insert option you choose you can be assured we have increased the central area of the Hex-Dec Duo by over 30%.

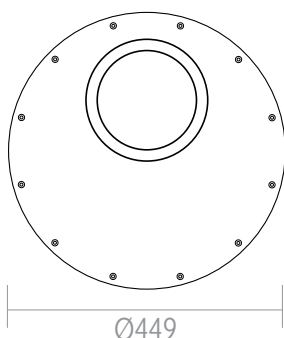
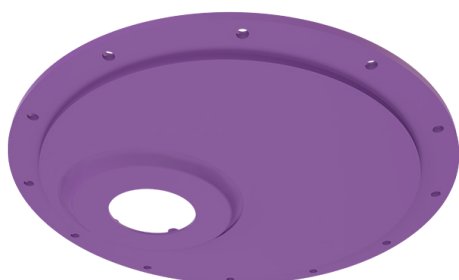

## Standard dish insert

- Available if preferred

This can be used with all standard gravity and pumped waste dishes.

**NEW**

**Honeycomb geometrical underside**

**PROCare**

- 1** Trim lines and reinforced ribs at 50mm and 100mm from the edges
- 2** Pre-drilled reinforced perimeter fixing holes (extra fixings at corners)
- 3** Manufactured in purple to highlight the multi trim lines and any additional markings the installer might require. Textured surface to provide a keyway for the flooring adhesive
- 4** Pre-formed falls
- 5** Offset waste position and rotatable plate to avoid joist floor obstructions
- 6** Honeycomb geometrical shape offers additional strength and rigidity providing the highest resistance to torsion or stress.
- 7** Extra strength ribs
- 8** Provides improved grip for bedding
- 9** Extra strength
- 10** Solid waste insert

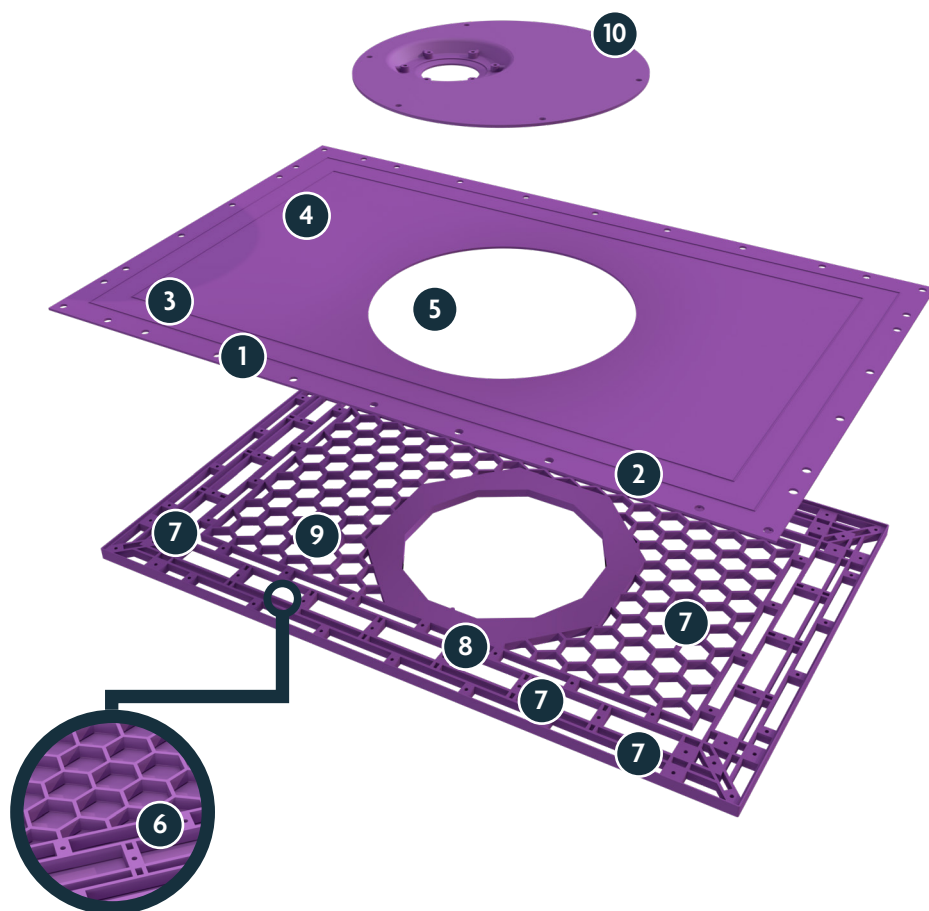

**Honeycomb structure  
provides high specific strength**



WOODEN  
FLOORS



SCREEDED  
FLOORS



LEVEL  
ACCESS



OFFSET  
WASTE



CORNER  
FITTING



ALCOVE  
FITTING



TRIMMABLE



PRO CARE  
LIFETIME  
GUARANTEE



PRO CARE  
PRO  
BRAND

01942 206004

[sales@procare-ltd.co.uk](mailto:sales@procare-ltd.co.uk)

[www.procare-ltd.co.uk](http://www.procare-ltd.co.uk)

# Hex-Dec Duo range of sizes

## Hex-Dec Duo 1000 x 1000

Code: 17-10001

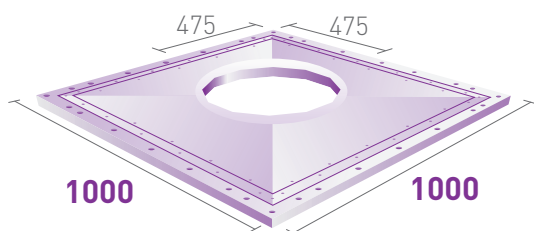

## Hex-Dec Duo 1150 x 750

Code: 17-10002

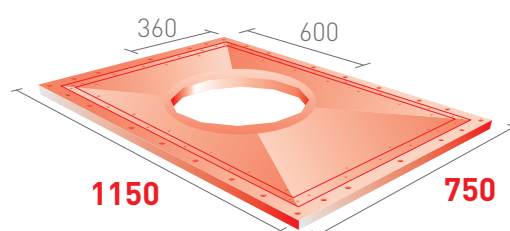

## Hex-Dec Duo 1200 x 1200

Code: 17-10003

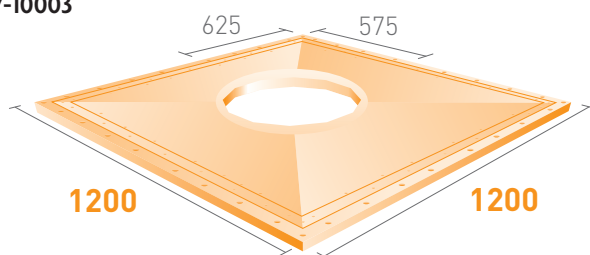

## Hex-Dec Duo 1300 x 800

Code: 17-10004

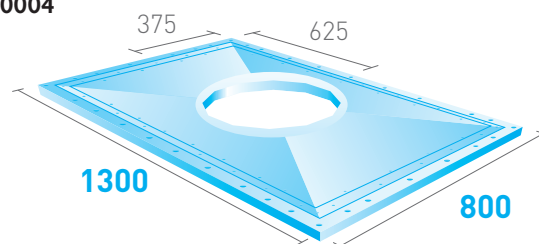

## Hex-Dec Duo 1400 x 900

Code: 17-10005

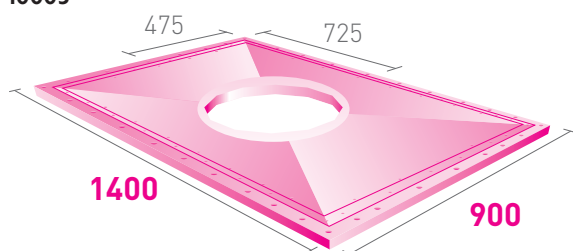

## Hex-Dec Duo 1500 x 800

Code: 17-10006

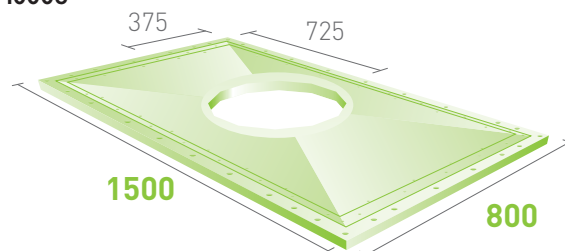

## Hex-Dec Duo 1700 x 800

Code: 17-10007

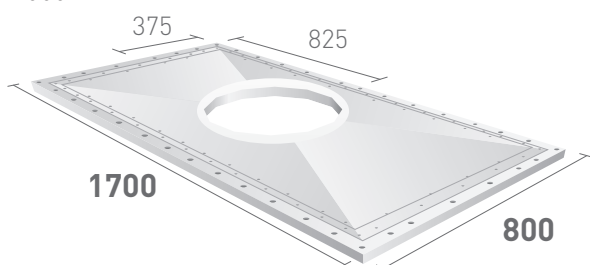

Prefer a  
standard dish?

You can change to a  
standard dish insert

Code: 17-10011